



FISH MATE®

POND PUMP 1200/1500/1800 MODELS

IMPORTANT - READ BEFORE USE
INSTRUCTIONS

IMPORTANT SAFETY INSTRUCTIONS

WARNING - To guard against injury or death, basic safety precautions should be observed, including the following:

READ AND FOLLOW ALL SAFETY INSTRUCTIONS

- All electrical work must be carried out by a competent electrician.
- Check that the voltage label on the motor (M) see Fig. 1 conforms with your supply voltage.
- The pump MUST be wired into an R.C.D./G.F.I. circuit breaker (maximum 30mA) and a 3 AMP (maximum) fuse. Ensure breaker is regularly tested in accordance with manufacturers instructions.
- Connection to the power supply should be made through a suitable dry weatherproofed 3 pin plug or double pole switched enclosure with minimum 3mm (1/8") contact separation in all poles. If product is hard wired to electrical supply this must comply fully with the wiring regulations of the national and local electricity authority. The pump must be protected by a 3 AMP (maximum) fuse.
- This appliance must be earthed. It is essential that all connections are securely made using the following code:

Brown - Live
Blue - Neutral
Green/Yellow - Earth

- Do not carry or pull the pump using the supply cord.
- Disconnect electrical supply from all appliances in the pond including pumps and filters before contact with the pond water or pump.
- Closely supervise children when near to pond or pond equipment.
- Use pump only for ponds - do not use pump in connection with swimming pools, showers, etc.
- Use conduit approved by your electricity authority to protect supply cord where damage from gardening equipment, children and animals may occur.
- Discard pump if motor (M) shows visual defects (e.g. cracks or swelling).
- The supply cord of this appliance cannot be replaced; if the cord is damaged the appliance should be discarded.
- Do not allow the pump to run dry
- Do not operate the pump in freezing conditions. Remove, disassemble and dry pump if there is a risk of pump being frozen.

SAVE THESE INSTRUCTIONS

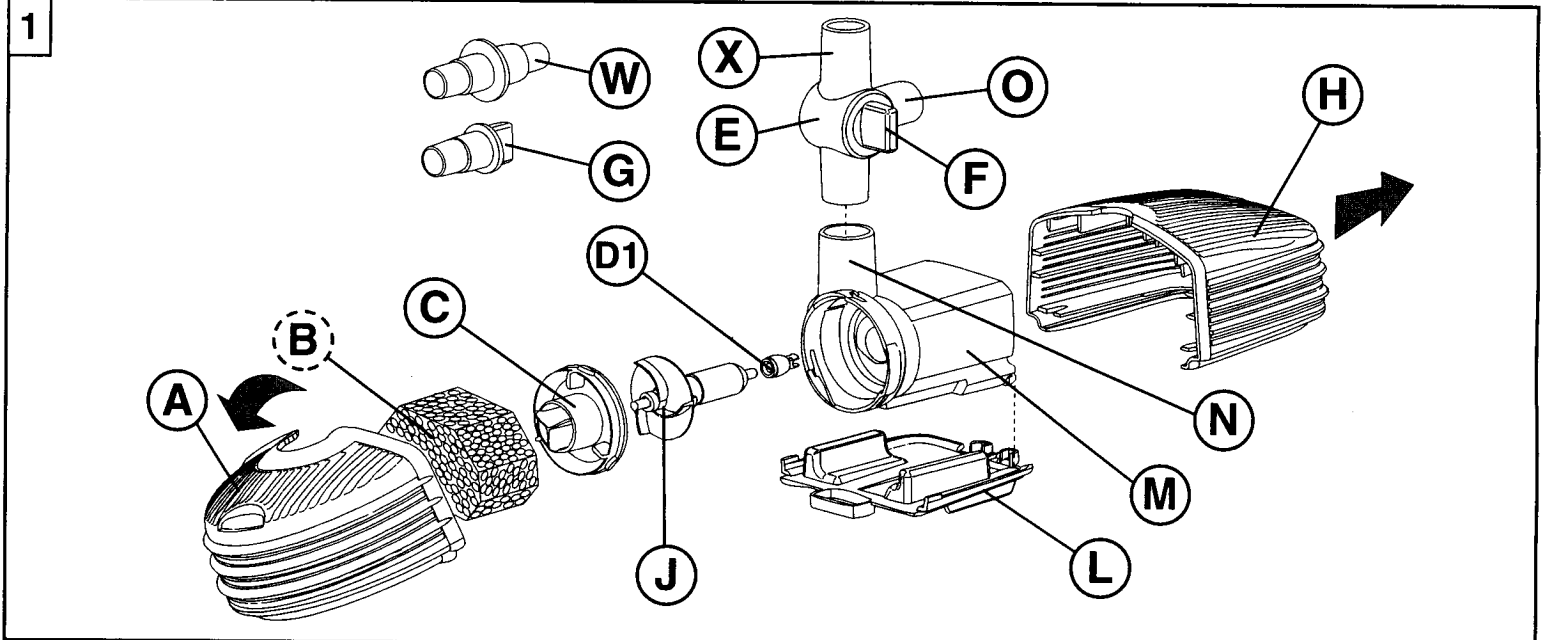
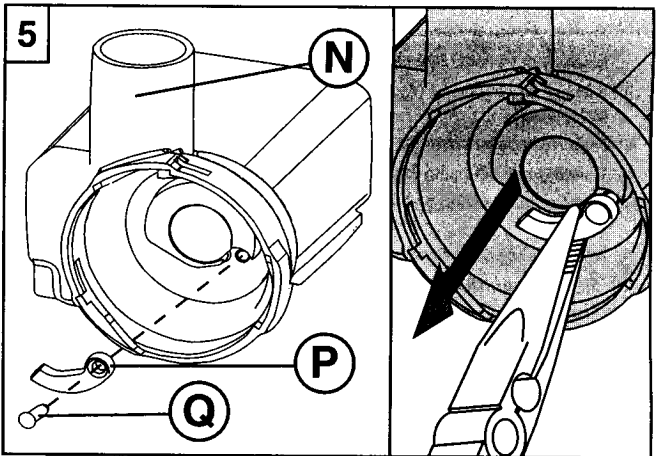
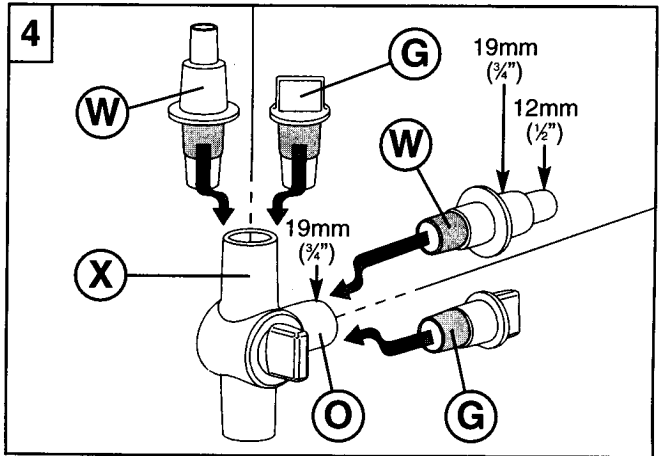
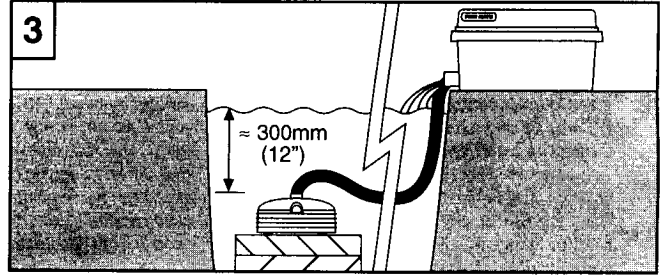

1. PUMP INSTALLATION

For use with a pond filter you will often get improved results with the pump sited at the opposite end of the pond to the filter return. The pump comes as standard with pond-life friendly 1mm (1/16") slots to help protect spawning life.

For convenience the pump should be positioned within reach from the side of the pond on a solid platform (e.g. paving slabs) approximately 300mm (12") below the pond surface. The pump should be at least 200mm (8") below water level to avoid problems of freezing and low water levels in summer. A typical installation with filter/waterfall is shown in Fig. 3.

A. Waterfall/Filter only

The pump may be connected to a waterfall or filter using 12mm (1/2"), 19mm (3/4") or 25mm (1") bore hose.

For maximum flow use 25mm (1") hose connected directly to the pump outlet (N). If control of flow rate is required fit flow valve (E) into pump outlet (N). Insert adapter (W) if required and connect hose to required outlet (see Fig 4). Insert plug (G) in unused outlet and adjust flow using the flow control knob (F).

B. Fountain (and Waterfall/Filter).

Insert fountain components as shown in Fig. 2a (conventional fountain) / 2b (bell fountain). If required tube (V) may be shortened with a hacksaw. For plume fountain do not fit any parts to tube (V). If required, connect waterfall/filter with hose to outlet (W or O). Alternatively, use blanking plug (G). We recommend using the foam filter (B) (not supplied - available separately) only if clogging of the fountain head is a major problem. The Fountain heads may be unscrewed anticlockwise for cleaning. Adjust fountain height/width using the flow control (F) turning clockwise for increased height. If using the bell fountain you will also need to manually adjust the gap between parts (T) and (U) for the required effect. (Try starting with approximately 1mm (1/16") gap.)

2. MAINTENANCE / FAULT FINDING

IMPORTANT SAFETY INSTRUCTIONS

• **Disconnect electrical supply from pump before removing from pond or contacting pond water.**

• **Do not carry or pull the pump by the cable.**

A. When flow from your pump is noticeably reduced or fountain display has deteriorated:

- i) Remove strainer cover (A) by twisting off as shown by arrow in Fig.1. Slide off cover (H). Clean covers with a brush and hose. Remove any weed or blockage on impeller cover (C).
- ii) If you are using a fountain:
 - a) Remove and clean fountain head in water with a brush.
 - b) If foam filter (B) is fitted, rinse in water until clean. (We only recommend fitting foam filter if fountain head clogging is a major problem).
- iii) Reassemble.

If flow is still poor check to see if outlet pipe has become kinked or blocked. If not then refer to section 2.B. below.

B. Once a year or if flow is stopped (check power supply first!):

Completely disassemble pump to the component parts shown in Fig. 1. Wash all parts in clean water and replace any worn or broken parts with items from the appropriate **FISH MATE** pond pump service kit before reassembling the pump.

The recommended disassembly / inspection procedure is as follows:

- i) Disconnect all items fitted to pump outlet (N).
- ii) Remove strainer cover (A) by twisting off as shown in Fig. 1. Slide off cover (H). Lift pump body (M) from baseplate (L).
- iii) Remove impeller cover (C) by rotating anticlockwise.
- iv) Carefully pull out pump impeller assembly (J).
- v) Remove rear bearing and mounting bush (D1) by squeezing end clips together whilst pushing firmly from behind.
- vi) After cleaning of all components:
 - Check for wear of bearings at either end of rotor and replace rotor assembly if required.
 - Check that one-way arm (P) (Fig. 5) moves freely. If not, carefully pull out with retaining pin (Q) using tapered pliers, and clean or replace.
 - Check cable and pump body (M) for any damage or deterioration and discard pump if suspected faulty.
- vii) Reassemble all parts in reverse sequence. Place rear bearing and plastic mount (D1) onto pump impellor assembly (J). Push until rear bearing and plastic mount (D1) clip into place.

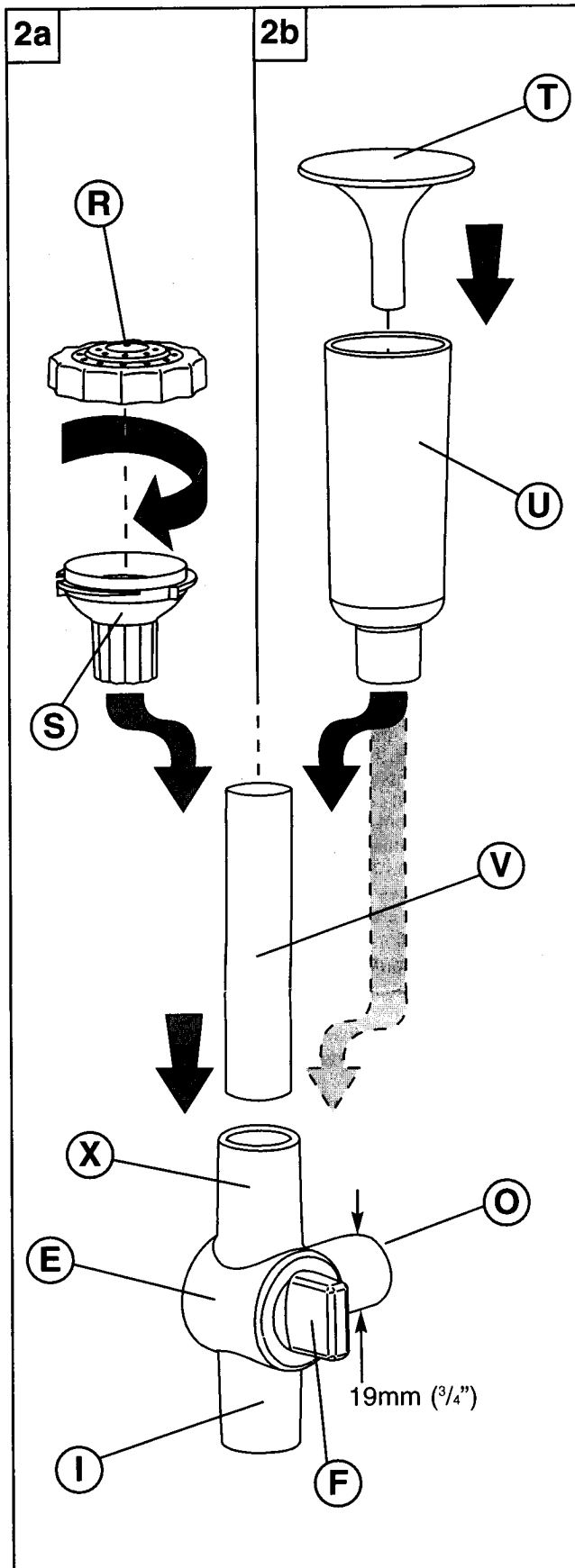

! HELPLINE ?
UK 01932 700 001
www.pet-mate.com
 Non UK call +44 1932 700 001

GUARANTEE
 This product is guaranteed for 3 years from the date of purchase subject to proof of purchase date. The guarantee is limited to replacement of the product arising from faulty materials or manufacture. The guarantee excludes claims arising from frost, dry running, accidental damage or loss of fish. Your statutory rights are not affected.

UV+**BIO** POND FILTER

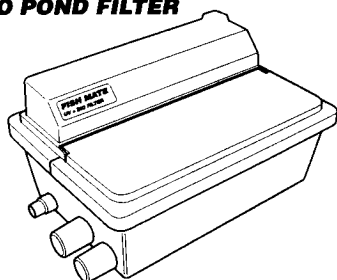

Other **FISH MATE** Products

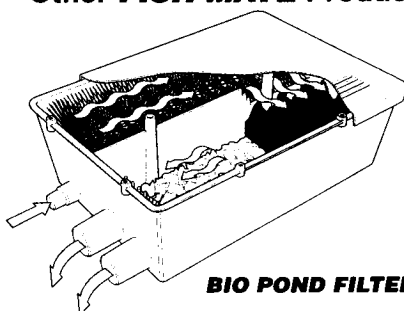

BIO POND FILTER

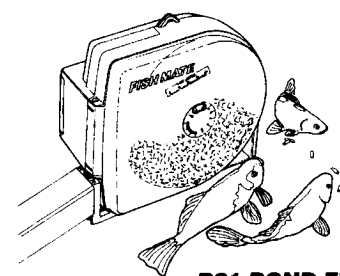

P21 POND FEEDER